

MACBro



Maxi Press

Wool press



Made in Australia by MACBro industries P/L Ballarat VIC 3350

For further information about any of the products shown please visit:
www.macbroindustries.com.au
© MACBro Industries 2010
This publication and all designs are copyright

No part, products or designs may be reproduced by any process except in accordance with the Copyright act 1968.

All information in this operator's manual is based on the latest product information available at the time of printing. The policy of MACBro is one of continuous improvement and as such, MACBro reserve the right to alter any specifications and designs without notice and without incurring any obligation regarding such changes.

No part of this manual may be reproduced without written permission from MACBro. All photographs and technical information remain the property of MACBro
MACBro Industries
Shed 1/5
Trewin Street
Wendouree Victoria 3355

www.macbroindustries.com.au

Ph: 03 5339 9741

Email: carlmacgill@yahoo.com.au

Contents

Introduction

Welcome

MACBro Warranty registration 3

Terms and conditions of sale 5

Safety 7

General 7

The Operator 7

Safety Precautions 8

Notes 8

Warnings 8

General Information & Specs 11

MACBro MAXI PRESS overview 11

Parts Ordering 11

Safety Decals 11

Key Features 12

Operation 13

Door closer operation 13

General operation 14

Maintenance & Troubleshooting 17

Maintenance 17

Lubrication 17

Oil & Filters 17

Troubleshooting 18

Chapter I

INTRODUCTION

Welcome

Thank you for purchasing a MACBro Maxi Press Wool Press. Please use this operator's manual to become familiar with the safe operation of this equipment. All operators must be competent in the machines operation prior to use.

If you have any questions regarding the operation, safety or service of this equipment please contact us for further information.

Kind regards

Carl & Darren Macgill
MACBro Industries

MACBro Warranty registration

This warranty registration form must be returned to MACBro. Only when this warranty registration card is completed and returned can MACBro fulfill all warranty obligations.

Dealer: _____ Postcode _____
 Address: _____ Serial # _____
 Product: _____
 Delivered _____ Date _____
 by: _____

Important:
 By executing this warranty registration:

- I. The Owner:
- a) Agrees that the operator will read the operator's manual before using the product, follow all procedures in the operator's manual for the use of this product, and will exercise due care in the use of this product;
 - b) Agrees that MACBro's liability for any loss or damage suffered by the owner in connection with the owner's use of this product is limited to the cost of repair or replacement of the product;
 - c) Agrees that the owner will bear any loss the owner suffers as a consequence of any failure by the owner to comply with I (a) above;
 - d) Agrees that the owner will fully train any person who might be required to operate the product as how to operate the product in a safe and proper manner.

*Note: The limited warranty period for this Woolpress is 24 calendar months from dispatch date and only extends to units that are on farm use. (Wool store or industrial-12 calendar months -unless specified other)

Owner Owner's name: _____ Address: _____ _____ Postcode: _____ Phone: _____ Mobile: _____ Signature of owner: _____ Date: _____	Dealer Dealership name: _____ Address: _____ _____ Postcode: _____ Phone: _____ Mobile: _____ Signature of dealer representative: _____ Date: _____
---	---

Please return to:

MACBro Industries
 Shed 1/5
 Trewin Street
 Wendouree Victoria 3355

Terms and conditions of sale

Interpretation:

In the terms and conditions of sales, warranty terms and conditions: "MACBro" means MACBro Industries Pty Ltd- of Shed 1/5Trewin Street, Wendouree - trading as MACBro which is the seller of the Goods - "Purchaser" means the purchaser of the Goods; "Goods" means the product and, if any, the services provided. Nothing in these warranty terms and conditions shall be read or applied so as to exclude, restrict or modify or have the effect of excluding, restricting or modifying, any condition, warranty, guarantee, right or remedy implied by law (including the Competition and Consumer Act 2010) and which by law cannot be excluded, restricted or modified.

General:

(1) The warranty terms and conditions (which shall only be waived in writing signed by MACBro) shall prevail over all terms and conditions of the purchaser to the extent of any inconsistency.

(2) This warranty may not be modified or added to without the expressed written consent endorsed hereon of a Director of MACBro.

Warranty Terms:

The warranty relating to the Goods and all other products sold and, if any, services sold or provided by MACBro are contained in these warranty terms and conditions.

Specifications: etc: Catalogues, etc: Quantities

All specifications, (without limiting the generality of same - including: drawings, particulars of weights, volumes, capacities, dimensions, load factors) are approximate only and any deviation shall not be taken to vitiate any contract with MACBro or form any claim against MACBro. The descriptions, illustrations and performances contained in catalogues, pricelists and other advertising matter do not form part of the contract of sale of the Goods. Where specifications, drawings or other particulars are supplied by Purchaser the prices made on estimates of quantities required. Should there be any adjustments in quantities above or below the quantities estimated by MACBro and set out in a quotation, then any such increase or decrease shall be adjusted on a unit rate basis according to unit prices set out herein.

Performance, Capacities, Chemicals, Liquids, Application Methods, Environmental Effects

Any performance, volumes, weights, and/or capacity figures given by MACBro are estimates only. MACBro shall be under no liability for damages for failure to obtain such figures unless specifically guaranteed in writing and any such written guarantee shall be subject to the recognized tolerances applicable to such figures. The suitability for application is the owners responsibility.

Limit of Liability

MACBro liability for Goods manufactured by it is limited to making good any defects by repairing the same, or at MACBro option by replacement, within a period not exceeding two calendar years*, after the Goods have been dispatched provided that;

- (a) The defects have arisen solely from faulty materials or workmanship;
 - (b) The Goods have not received maltreatment inattention or interference
 - (c) Accessories of any kind used/manufactured by the purchaser with the goods have been approved by MACBro;
 - (d) Where applicable, the seals on the Goods remain unbroken;
 - (e) There has been no inadequate or incorrect use, storage, handling or application of the Goods;
 - (f) There has been no use or operation of the Goods outside of the physical, electrical or environmental specifications at the Goods;
 - (g) There has been no inadequate or incorrect site preparations;
 - (h) There has been no inadequate or improper maintenance of the Goods;
 - (i) It has not been caused by fair wear and tear; and Firstly the Goods have been thoroughly inspected and any damage (from whatever cause) to the Goods (and in particular the structure, welding, seams, bolts etc).
 - (k) There has been no failure to comply with the requirements of all present or future laws or regulations relating to the Goods and/or the use and/or the operation of the Goods; and there has been no failure to maintain the goods
 - (l) The defective Goods or any damaged part of the Goods are promptly returned **free of cost to MACBro.**
 - (m) All warranty related repairs have been carried out with the prior authorization of MACBro;
 - (n) If goods or any part thereof are not manufactured by MACBro, the guarantee of the manufacturer thereof shall be accepted by the purchaser and is the only guarantee given to the purchaser in respect of the Goods or that part; MACBro shall not be liable for, and the purchaser releases MACBro from, any claims in respect of faulty or defective design of any goods supplied unless such a design has been wholly prepared by MACBro and the responsibility for any claim has been specifically accepted by MACBro in writing and in any event MACBro liability hereunder shall be strictly limited to the replacement of defective parts in accordance with paragraph 6 (i) of these conditions;
- except as provided herein, all express and implied warranties, guarantees and conditions under statute or general law as to the merchantability, dissipation, quality, suitability or fitness of the Goods for any purpose or as to design, assembly, installation, materials or workmanship or otherwise are hereby expressly excluded and MACBro shall not be liable for physical or financial injury loss or damage or for consequential loss or damage of any kind arising out of the supply, layout, assembly, installation or operation of the Goods or arising out of MACBro negligence or in any other way whatsoever; this warranty shall only be available to the Purchaser and shall not be transferable by the Purchaser; this warranty in no way extends to any used Goods.

MACBro liability for a breach of condition or warranty implied is hereby limited to:

In the case of Goods, any one or more of the following:

where the law implies consumer guarantees into these terms and conditions pursuant to Part 3.2 Division 1 of Schedule 2 to the Competition and Consumer Act 2010 ("Cth") ("consumer guarantees") which cannot be excluded and MACBro breaches a consumer guarantee, the loss and damage the purchaser is entitled to at law which cannot be excluded by these terms and conditions;

- The replacement of the Goods or the supply of equivalent Goods
- The repair of the goods;
- The payment of the cost of replacing the Goods or acquiring the equivalent Goods;
- The payment of having the Goods repaired; or

In the case of services;

The supplying of the services again; or

The payment of cost of having the services supplied again.

Chapter 2

SAFETY

General

The following pages outline important safety information. At MACBro safety is a high priority. These safety and warning instructions MUST be followed to ensure the safe operation of your MACBro equipment.

Explanation of key terms used in this operator's manual are:

Danger

You will be killed or seriously hurt if you don't follow instructions

Warning

You can be seriously hurt if you don't follow instructions

Caution

You can be hurt if you don't follow instructions

Note

Is used to notify people of installation, operation or maintenance information that is important but not hazard related.

The Operator

All operators of this equipment should be adequately trained in the safe operation of this equipment, it is important that all operator's have read and fully understand the operators manual prior to using this equipment.

All new operators should be trained in an area without bystanders or obstructions and become familiar with the wool press prior to operation.

Safety Precautions

Notes

- Always read, and understand, the operator's manual prior to operation of this equipment
- It is the responsibility of the operator to ensure that there are no decals missing from the equipment and that any damaged, or missing, decals are replaced prior to operation.
- MACBro equipment ordered, or operated, outside the guideline limitations may not be warranted by MACBro for successful performance. Operators working outside these limitations do so at their own risk, unless specific advice has been sought from, and provided by: MACBro in writing.
- Inspect the equipment thoroughly for damage and wear before operator.
- Lubricate the equipment as per recommended requirements before operating.
- Do not operate the equipment while under the influence of any drugs, alcohol or if excessively tired.
- Make sure that the equipment complies with all relevant load regulations when transporting.
- When draining fluids from the equipment use appropriate, leak proof containers, do not use food or beverage containers because someone may consume the contents by mistake.

Warnings

ENTANGLEMENT IN ROTATING DRIVE LINES

Rotating drives, rollers can cause serious injury or even death when entanglement occurs. Keep hands, feet hair and clothing away from all moving parts to prevent injury: Never operate this machine with covers, shrouds, or guards removed.

PERSONAL PROTECTIVE EQUIPMENT (PPE)

Always wear close fitting clothing and safety equipment designed for the job.

Exposure to loud noise over an extended period can cause impairment or loss of hearing. Be active in the conservation of your hearing and wear appropriate hearing protection at all times.

DO NOT HEAT PRESSURIZED FLUID LINES

When conducting any process on the machine that involves heat; be aware of pressurized fluid lines in the vicinity of your work area

Pressurized lines can be easily cut when the heat over shoots the target object.

FLUIDS UNDER PRESSURE

Fluids escaping from high pressure lines can cause serious injury to skin. Hydraulic oil can easily penetrate human skin. This hazard can be avoided by

-relieving the pressure in the system.

Do not disconnect any hoses or fitters while equipment is operating. Disconnecting these components while under pressure may result in uncontrolled fluid discharge which may be hazardous.

When the repair is complete ensure that all fittings and lines are secured before re-applying pressure.

- Do not operate wool press without guards fitted and in the operating position
- Do not guide wool in with hands - keep hands clear when pressing.
- Do not operate with damaged hydraulic hoses
- Check all pivot pins and cylinder clevis' regularly for wear damage and integrity
- Do not leave the platen in the raised position when travelling, or at any other time other than when in the process of pressing wool.
- Do not open electrical cabinet .This should only be done by a qualified person. Please unplug prior to opening *HIGH VOLTAGE.

Chapter 3

GENERAL INFORMATION & SPECS

MACBro Maxi Press overview

Machine Limitations:

All MACBro equipment is subject to operating limitations, it is the operator's responsibility to ensure that this equipment is being operated within these limitations and appropriately to the operating conditions at hand.

Custom built equipment:

Where the owner of this wool press has requested that custom built equipment or options be fitted to this wool press it is necessary to understand that custom fabrication and engineering is subject to many

variables. MACBro cannot fully field test all custom built options prior to dispatch, and owners of new wool presses fitted with custom built equipment, or options, need to understand that the functionality of these items may require refining in order to operate as desired.

Parts Ordering

When ordering parts please quote:

- Serial No.
- Part No. required
- Part Description
- Quantity Required

When returning parts to MACBro, or to a MACBro dealer, for service or repair all parts MUST be cleaned thoroughly before sending them.

Note:

Please ensure that all parts are clearly labeled with

the owner's details, and a brief description of the fault MACBro are not liable for the return of any goods to MACBro or a MACBro Dealer. The goods must be returned to the point of sale.

The customer will be responsible for any cost incurred by a MACBro appointed person travelling to any site outside the point of sale.

Genuine MACBro parts only should be used on MACBro equipment

Safety Decals

Understanding safety decals and their purpose assist's in the safe operation of your wool press. Safety decals are there for your protection and it is the responsibility of the owner operator to replace damaged and/or missing safety decals.

Regularly review safety decals with operators. It is very important to ensure that all new machine components and replacement parts include current hazard identification decals.

Replacement safety decals can be ordered from all MACBro dealers.

Key Features

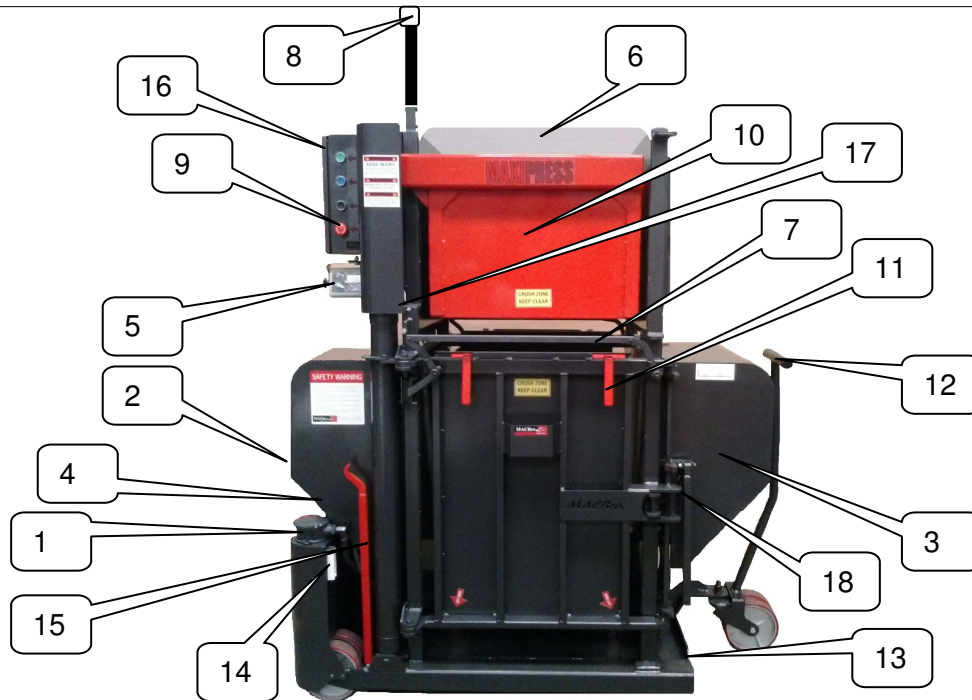

Number	Description
1	Hydraulic Oil Filter
2	On/Off switch-DOL
3	Spike in/out - Proximity switches (under covers)
4	Hydraulic oil tank filler cap
5	Scale monitor
6	Flap door
7	Safety bar
8	Top Limit Switch
9	Controls-up, down, pins out, Stop-(open, close-door closer opt)
10	Platen
11	Pack clamp
12	Jockey wheel
13	Scale foot
14	Hydraulic oil level sight gauge
15	Door bar (not on door closer model)
16	Electrical cabinet- HIGH VOLTAGE
17	Bottom Limit Switch
18	Main Door Handle

1: MAIN CONTROLS

1.1 Main Control Panel

Refer to the control panel shown in section 2.

Operators are:

- Down-Cycle run button.
- Press raise button. (Manual up)
- Pins out button.
- Emergency stop button
- Door- open/close *option

1.2 DOL Start / Stop buttons

This button is mounted on oil tank; it starts the motor and the system hydraulics. The indicator will light when the control system is active.

1.3 Down -Cycle Run Button

Initiates the press run cycle. The cycle will continue to run until the Platen returns to the top position or the cycle is terminated by pushing the Emergency stop, or the Safety switches have been tripped. If the cycle is interrupted (stopped) the press must be raised to the top position before another function can occur

1.4 Press Raise Button -UP

This button is used to manually raise the press. The Platen will stop when the press is at the upper limit.

1.5 Pins Out Button

This button is used to manually extract the pins at the end of a bale after capping off. This must be used before trying to open main door (interlock fitted to door handle)

1.6 Emergency Stop Button

This button will stop all press functions.*Except door closer if fitted, this will only operate when stop button is pushed.

1.7 Door Open/Close Button (option)

These buttons are used to place a half bale (butt) back into press *optional.

2: CONTROL PANEL- Door closer

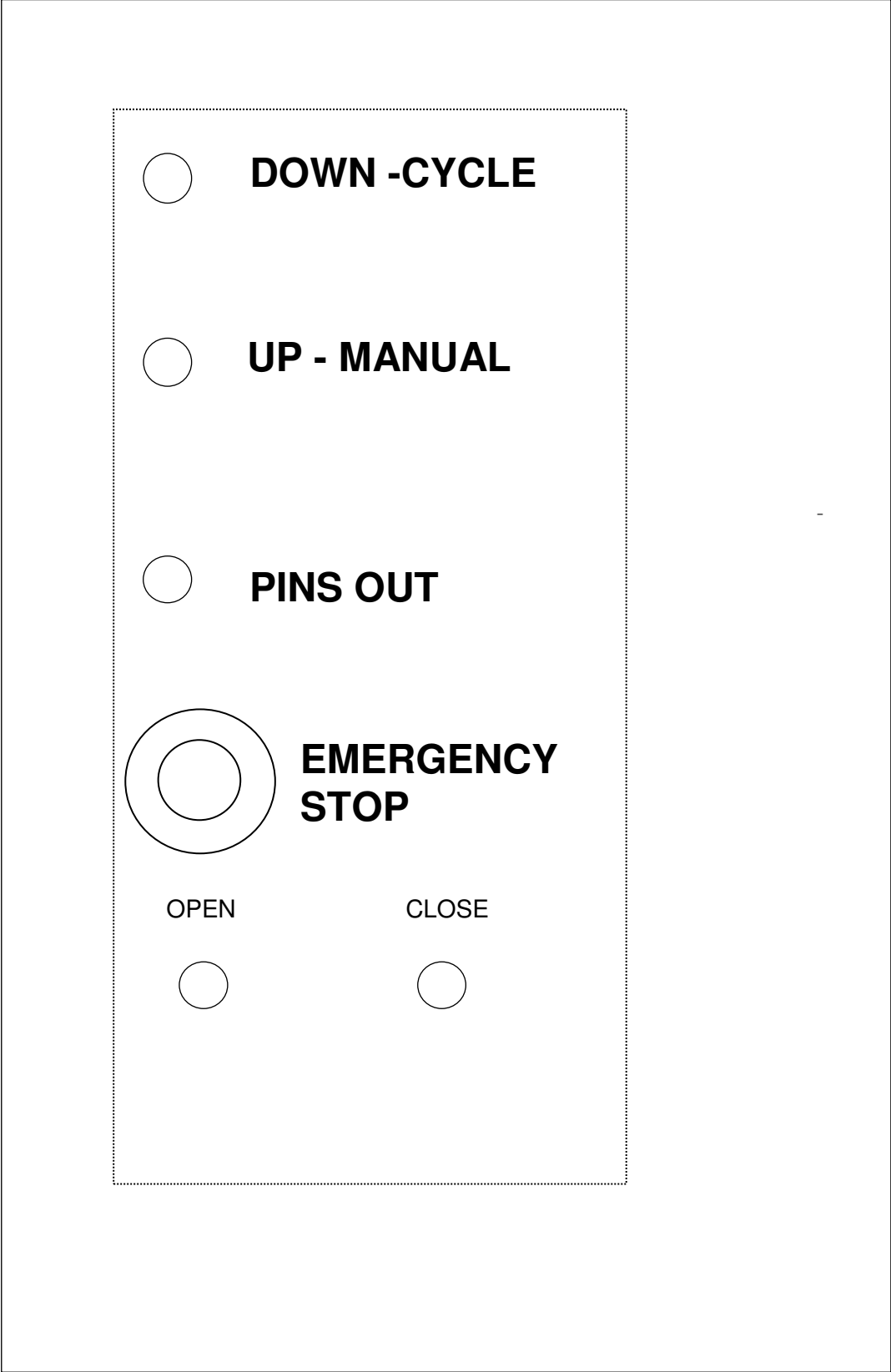

3: OPERATING CONTROLS

Controls on the Press

- Press upper proximity switch
- Press lower proximity switch
- Pins inner proximity switch
- Pins outer proximity switch
- Door safety switches

3.1 Press Upper Proximity Switch

This switch stops the upward travel of the press. The auto loading cycle is also initiated by this limit.

3.2 Press Lower Proximity Switch

This switch stops the downward travel of the press. The pinning cycle is also initiated by this limit.

3.3 Pins Inner Proximity Switch

This switch stops the inward travel of the pins. The upward travel of the press is initiated, and the downward travel prevented by this limit.

3.4 Pins Outer Proximity Switch

This switch stops the outward travel of the pins. The downward travel of the press is permitted by this limit.

3.5 Door safety Switches

There are three door safety switches. Operation of the system is prevented when any door is open and the safety circuit is broken. *except door closer*

4: OPERATION

Standard operation:

- Manual loading
- Auto loading- (if fitted)

4.1 Standard Operating – Manual Loading

- 1: Set required bale weight.(using scale monitor)
- 2: With all doors closed, press the 'DOL Start button' to start motor, allow to warm up for 5 minutes on first start up*. Then use the 'PRESS RAISE' button to raise the press to maximum height.
- 3: Open the doors and fit a new pack, using the pack clamps to hold in place.
- 4: With only the top door open, fill the bale chamber to capacity, and press the Down – cycle button to compact material, press will return to top. Repeat this procedure until the full alarm sounds and the set weight is achieved.
- 5: Open the top door, remove pack clamps and 'cap' off the bale.
- 6: Press the 'PINS OUT' button until to remove pins from bale. (This must be done prior to next step)
- 7: Open main door and remove the bale.
- 8: Return to step 3.

4.2 Standard Operating – Automatic Loading (if fitted)

- 1: Set required bale weight.
- 2: Set the load time required. This is the time the auto loader will feed into the chamber after the first cycle is completed.
- 3: With all doors closed, press the 'CONTROL ON', and then the 'PRESS RAISE' buttons to raise the press to maximum height.
- 4: Open the doors and fit a new pack.
- 5: Close all doors.
- 6: Press the 'CONTROL ON' button, control indicator will light.
- 7: Check the 'PRESS UP' indicator is light, if not manually raise by pressing the 'PRESS UP' button.
- 8: Press the 'RUN' button. The press will cycle and load automatically until the set weight is achieved or the cycle terminated. The 'RUN' indicator will be illuminated.
- 9: The full alarm will sound when the set weight is achieved and the 'CYCLE RUN' will be terminated. *One more manual pressing cycle will be permitted.*
- 10: Open the top door and 'cap' off the bale.
- 11: Press the 'PINS OUT' button until the light illuminates.
- 12: Open all doors and remove the bale.
- 13: Return to step 4.

4.3 Door closer operation (If fitted)

To place a half bale (butt) back into press-

With press in up position and pins out:

1. Press STOP button.
2. Open door and Place Butt into chamber as square as possible.
3. Close main door by hand as far as possible (slam against bale).
4. Press OPEN button-releases cable to pull out and hook to main door.
5. Press CLOSE button-retracts cable, thus closing door.
6. Once closed, CHECK that latches are fully engaged and closed.(if just ajar, apply pressure to door to fully close)
7. Press OPEN button to release hook cable.
8. Press CLOSE button to re-store hook cable.
9. Release STOP button, to continue normal pressing operation.

NOTE: These buttons only operate when stop button is pushed, and as such are 'inch' only buttons (only moves when button held in-max 4 secs*)

When operating door closer the operator must:

1. Only refit Butts, or loosely packed bales into press.
2. Wear all appropriate PPE for this job.
3. Keep all bystanders clear of press, and warn anyone nearby.
4. Keep hands, and any other body part clear of door latch.
5. Once door is closed and bale has been refitted, check that latch is fully engaged, before pressing open/close (to store cable).

5: SHUT DOWN PROCEDURE

The press operation will be terminated when either stop button, or one of the doors are opened. A restart is possible when all doors are closed and all stops raised.

5.1 Press Shutdown Procedure

- 1: Close all doors
- 2: Press the 'DOL Start' button
- 3: With the press in the upper position, press the 'Down' button
- 4: When the press has reached the mid position the pins will come out, press the 'STOP' button when pins retract (this will keep pins out to allow door latch to still operate, and be at a height that a forklift can be used to pick up under the platen if required.
- 5: Turn off the power.

5.2 Press Re-start Procedure

- 1: Close all doors, check safety bars.
- 2: Press the 'DOL start' button. (*Allow to warm up if first cycle)
- 3: Press the 'PRESS RAISE' button.
- 4: Press the 'PINS OUT' button.
- 5: Run a cycle and test all safety and stop switches are operating correctly, IE: stopping press.
- 6: Refer to section 4 for normal operating procedure.

Chapter 5

MAINTENANCE & TROUBLESHOOTING

Maintenance

The maintenance information is provided as a reference for the preventative maintenance of your wool press.

To ensure that you receive the best possible service, it is recommended that you carry out preventative maintenance on a regular basis and exhaust all applicable troubleshooting solutions prior to calling your dealer or MACBro for service advice.

Lubrication

Control valve shaft bushes/pivots	Oil	Cables / pulleys	Grease /oil
Push rods/ linkage	Oil	Handle pivot	Oil
Front door & side door hinge pins	Oil	Spike blade	Oil/ WD40
Wheels	Grease		
Latches/catches	grease		
Door latch slides	Anti seize		
Flap door bushes	Grease		

Oil & Filters

Changing the oil and filter is the most important Maintenance to be carried out. Perform the following service when the first criteria has elapsed, Either bales or time.

First 100 bales or 12 months - Filter only.
Every 300-500 bales or 36 months - Oil and filter.

To change the filter, it is simply a matter of unscrewing the lid (3 x screws) and replacing the inner filter with a new one. (or check and clean)

The oil can be changed by unscrewing the drain plug located at the bottom of the oil tank. Remove any particles on the drain plug..This is an integral part of checking the systems clean. The oil tank holds approximately 50 litres of oil. With the platen in the down position the oil level should be midway in the sight glass located on the side of the oil tank.

Oil

Quality HVI 68 grade, hydraulic oil should be used. Note: Cold temperatures may cause the motor to draw excessive current (amps) until the hydraulic oil gets up to normal operating temperature.

In extremely cold operating conditions, a lighter grade oil may be required - an ISO 46 - (or 32 for the EVOLUTION model, normally 46) viscosity.

NOTE: std Maxi Press MACBro uses HVI 68.

6: PREVENTATIVE MAINTENANCE

To ensure continuing trouble free and efficient operation of the press a few basic checks should be carried out.

6.1 Oil Leaks

This machine has not been fitted with a drip tray, so it is important that any oil leaks are attended to without delay. Visual inspection of hoses and fitting points should be carried out weekly and any offending points reported to the maintenance fitter responsible.

6.2 Oil Level

It is a good practice to check oil level regularly(should be around 1/2way on the sight glass when press is fully down) Suggested weekly, top up as necessary.

6.3 Hydraulic System

The system has been fitted with a return line filter; this should be changed/cleaned every 1000 hours operation.

6.4 Grease and lubrication

The machine has been fitted with high wear resistant latches and catches, but it is still recommended to lubricate weekly to keep in good condition- See below

Door latches- Grease- Weekly.

Door hinges- Oil-Weekly.

Door handle shaft- Oil-Weekly.

Spike pivots (fitted with a brass bush and anti wear lube)-Oil-weekly.

Hinge side pivots-Oil Weekly

Check oil moving pivots and oil as necessary.

Inspect door closer cable/connectors-Weekly

6.4 Cleaning

The machine should be cleaned daily.

7: FAULT CHECKLIST

Fault	Description	Possible Cause
1	Press motor won't start	Power supply not connected or lead is faulty. Fuse blown. DOL overloaded on press.
2	Press motor starts but hydraulics don't work	Motor may be running backwards if press has just been moved or installed to a different power socket. Power supply to PLC or solenoids Blown hydraulic hose in tank. Pump/coupling failure.
3	Press stops during cycle	Safety switch has activated, or stop button pushed. Check safety bar switches. Press failed to reach either upper or lower limit within the required time. Check for machine obstruction, hydraulic or proximity switch failure.
4	Door handle will not lift	Pins are still in, press Pins out button and try handle again
5	Press wont press weight into bales	Check Pressure Relief Valve. Piston seals. Material not suitable to press.
6	Scales are out	Re-calibrate scale using known weight

Maxipress unpack/set up procedure.

***Note: When moving press on pallet, use extreme care as these are quite top heavy, also when loading onto transport etc, make sure load is strapped through base of press (below door), no ropes over top or on fragile areas.**

*******UNPACK AND READ AND UNDERSTAND THE HAND BOOK FIRST*******

1. To unpack press, carefully remove cling wrap and any bubble wrap.
2. Find **scale foot** in bale clip box and unwrap
3. Using forklift and extreme care lift press where 'lift here' decals are below door lower member.
4. Remove pallet by cutting steel strapping.
5. Fit the **scale foot** into the load cell socket (clips in) behind jockey wheel.
6. Carefully lower press down *DO NOT DROP as this will damage scale.
7. Stand top switch arm up- found at top of press, this is done by removing the left loose bolt in its bracket, then lift arm 90° replacing bolt into top hole and tighten.
8. Unwrap power lead from around motor top and inspect lead.
9. Check all packing is now removed and press is ready to start.
10. Plug three phase plug into 415 V 10A (min) outlet.
11. Press the start (green) button on DOL starter on motor.
12. Release stop buttons and make sure doors/safety bars are closed etc.
13. Press the UP (Yellow button) on control panel, the platen should raise to the top limit switch.
14. If not check that motor is not running backwards, *will sound quieter than usual- should this be the case get an electrician to swap two of the phases in plug to remedy.
15. Once press has been raised to top switch and operator has read and understands the hand book, and has been trained how to use these type of press. You can press the cycle (green) button on control panel and check the press does a complete cycle back to the top, and spikes will now be in. If all OK go to 16.
16. Press spikes out button (black) spikes will retract, and press now ready for pack to be inserted and scale to be set.
17. Turn on scale using toggle switch on under side, once it has settled press Zero button on front scale panel, should now show 0.
18. Fit empty pack into press and follow pressing instruction from hand book.

If any of above does not make sense or you have any questions on set up or press/scale operation please call Macbro direct during office hrs on 03 5339 9741 for help.

Attention!

When moving Maxi press around wool store on wheels, once in new position, lower the press gently until the Scale foot rests on the floor.

Do this by placing your foot against the wheels[^] as you slowly move the Jockey wheel handle to the rest position* DO NOT let go of the handle and allow too drop to the floor as this will damage scale load cell and void warranty!

